



**Govardhan**<sup>TM</sup>  
ASPIRING LEGACY



UNVEIL THE PINNACLE OF  
**RETAIL & WORKSPACES**



PRESENTING

**aarambh**  
સાસવટ

@ LAMBHA, AHMEDABAD

BUSINESS | RETAIL | LIFESTYLE | COMMUNITIES



## TRANSFORMING DREAMS INTO REALITY: GOVARDHAN'S COMMITMENT TO EXCEPTIONAL PROPERTY EXPERIENCES

At Govardhan, we are consistently focusing on transforming your property dreams into reality. We owe this monumental success solely to our happy customers who trust our work ethics and dedication. We make sure that with every project we design and deliver, we are consistently exceeding the expectations of our customers and investors. We understand that owning a property is a matter of pride, satisfaction, and success. We endeavor to make the entire property buying process as hassle-free and as rewarding as possible. As we are charting a new future with many projects in the pipeline, let's join hands to make your aspirations and dreams a reality. You can trust us to create individual and unique living spaces tastefully defined to deliver the best for you.

### **Clients First – Always**

We always promote the best interests of our clients by aligning our values together and delivering only the best experiences to our customers.

### **Trust and Transparency**

Our business is built on trust and transparency, and we are always open and accessible. And, we deliver what we promise.

### **On-time Delivery – At all times**

We are focused on delivering all the projects on the scheduled time without compromising quality, legality, and value.

### **Quality**

Quality is not a by-line in our brochure – it is a code by which we run our business – quality in work, communication, and service.







**aarambh**  
 सारम्भ  
 RETAIL & WORK SPACES



Begin your success story in our meticulously crafted real estate development, where perfection meets unparalleled connectivity. Immerse yourself in the perfect blend of opportunity and convenience within a thriving neighborhood.





# aarambh

ॐॐॐॐॐॐॐ

RETAIL & WORK SPACES

AARAMBH, in a Prime Location, is a striking G+5 Floor building with G+1 Floors of Retail space and 4 Floors of Offices. Featuring a stunning facade and 55 exclusive shops and offices, it ensures high visibility, excellent footfall, and easy accessibility for successful businesses.



ONLY 55 UNITS



WELL-DESIGNED



PRIME LOCATION



CONNECTIVITY



WHERE PRIME LOCATION MEETS  
STUNNING DESIGN FOR BUSINESS SUCCESS!

OFFICE SPACE

RETAIL SPACE &  
SHOWROOMS







## OFFICE SPACES TRANSFORMED: ENHANCED EXPERIENCE AND NATURE CONNECTION

Terraces and green spaces emerge organically from architectural design, serving to fulfill the demand for open green areas. These elements not only infuse vitality and freshness into conventional office settings but also empower occupants to shape their vistas, enhancing their overall experience.



Our building boasts high-speed passenger elevators from basement to 5th floor, plus a versatile Vehicle elevator to the terrace. Wide 10ft corridors and a grand entrance foyer add to the luxury experience.



HI-SPEED  
PASSENGER  
ELEVATORS



HI-SPEED  
STRETCHER  
ELEVATORS



MORE THAN ONE  
REASON TO STAY AHEAD



WIDE  
CORRIDORS  
10 ft



# BASEMENT PLAN

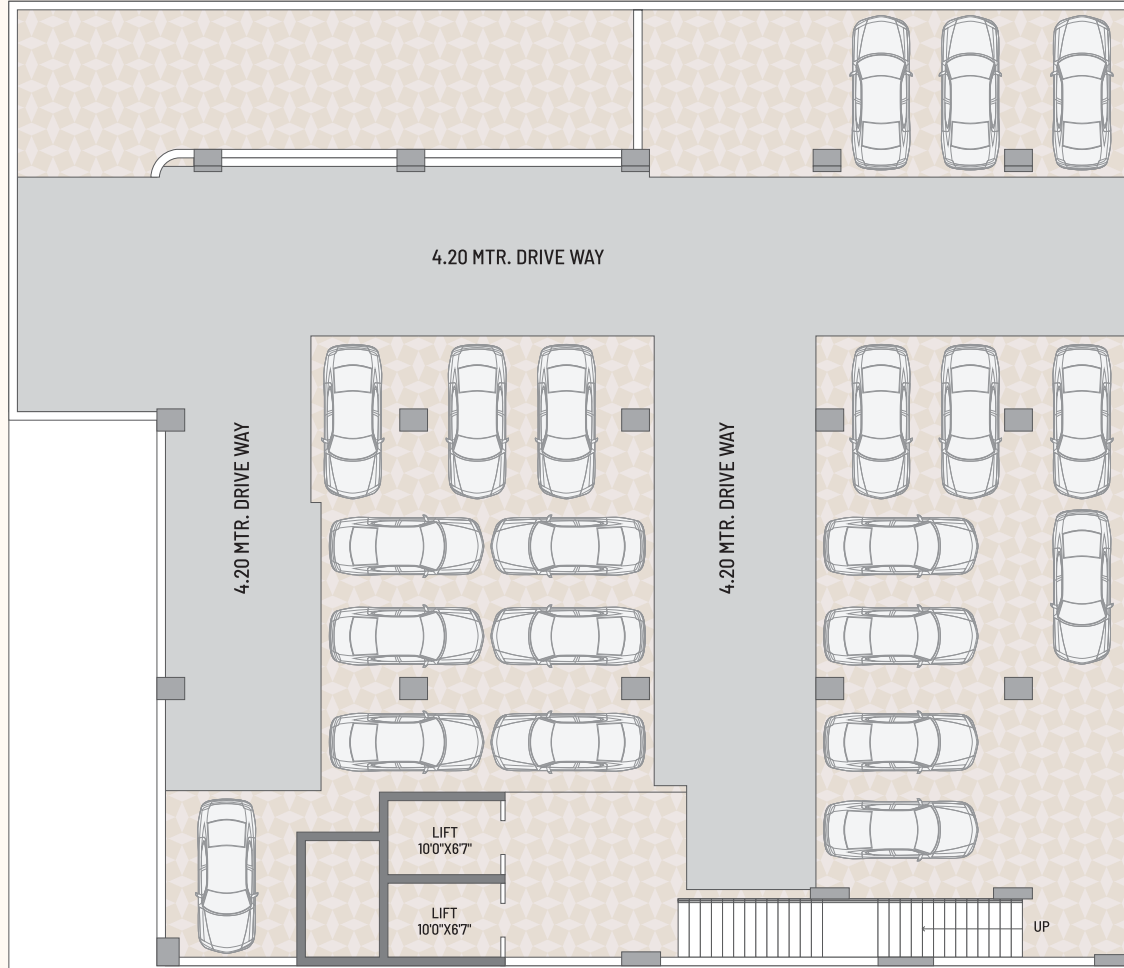

24.00 MT WIDE TP ROAD



# GROUND FLOOR PLAN

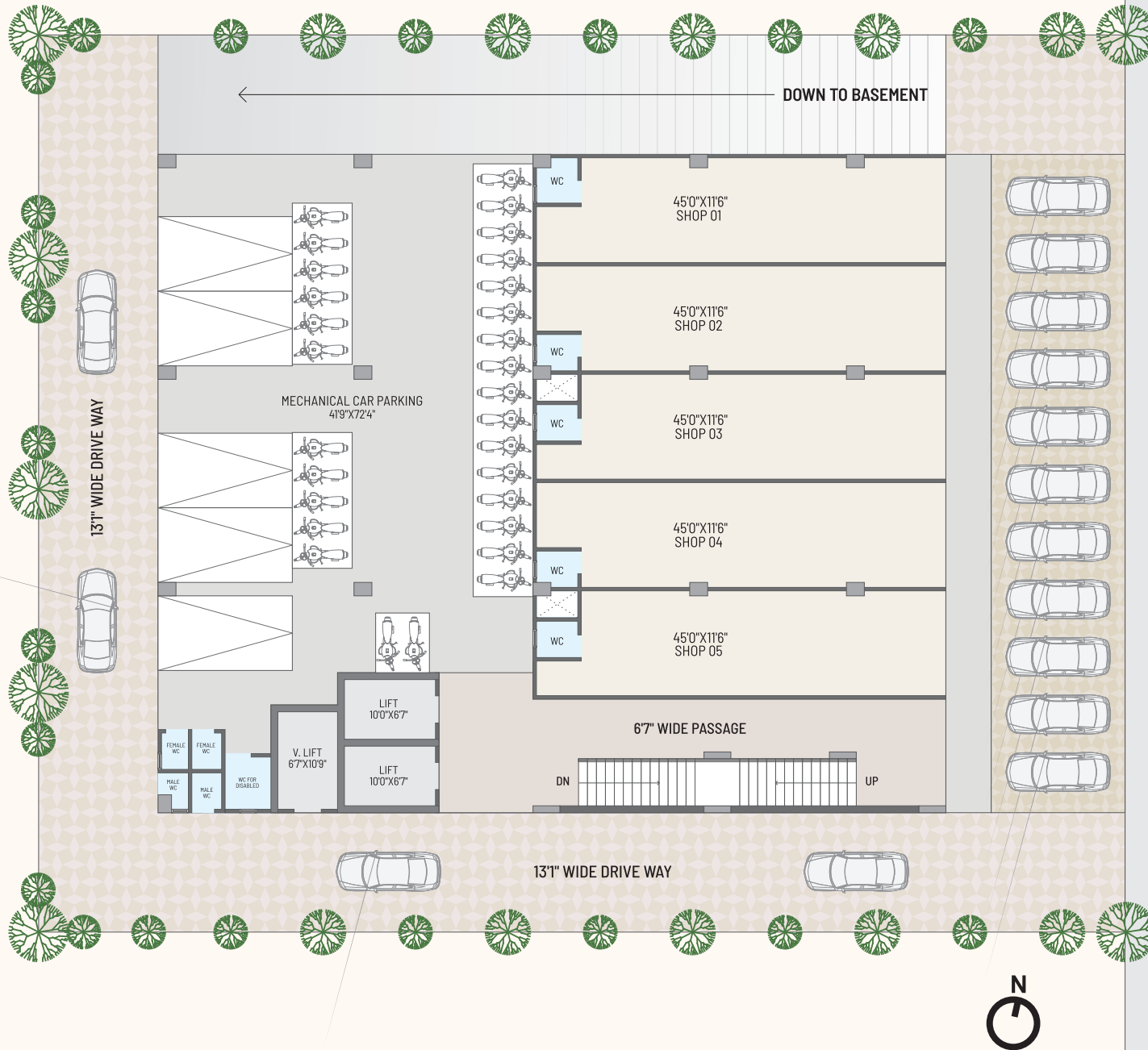

24.00 MT WIDE TP ROAD

# 1ST FLOOR PLAN





## 2ND TO 5TH FLOOR PLAN

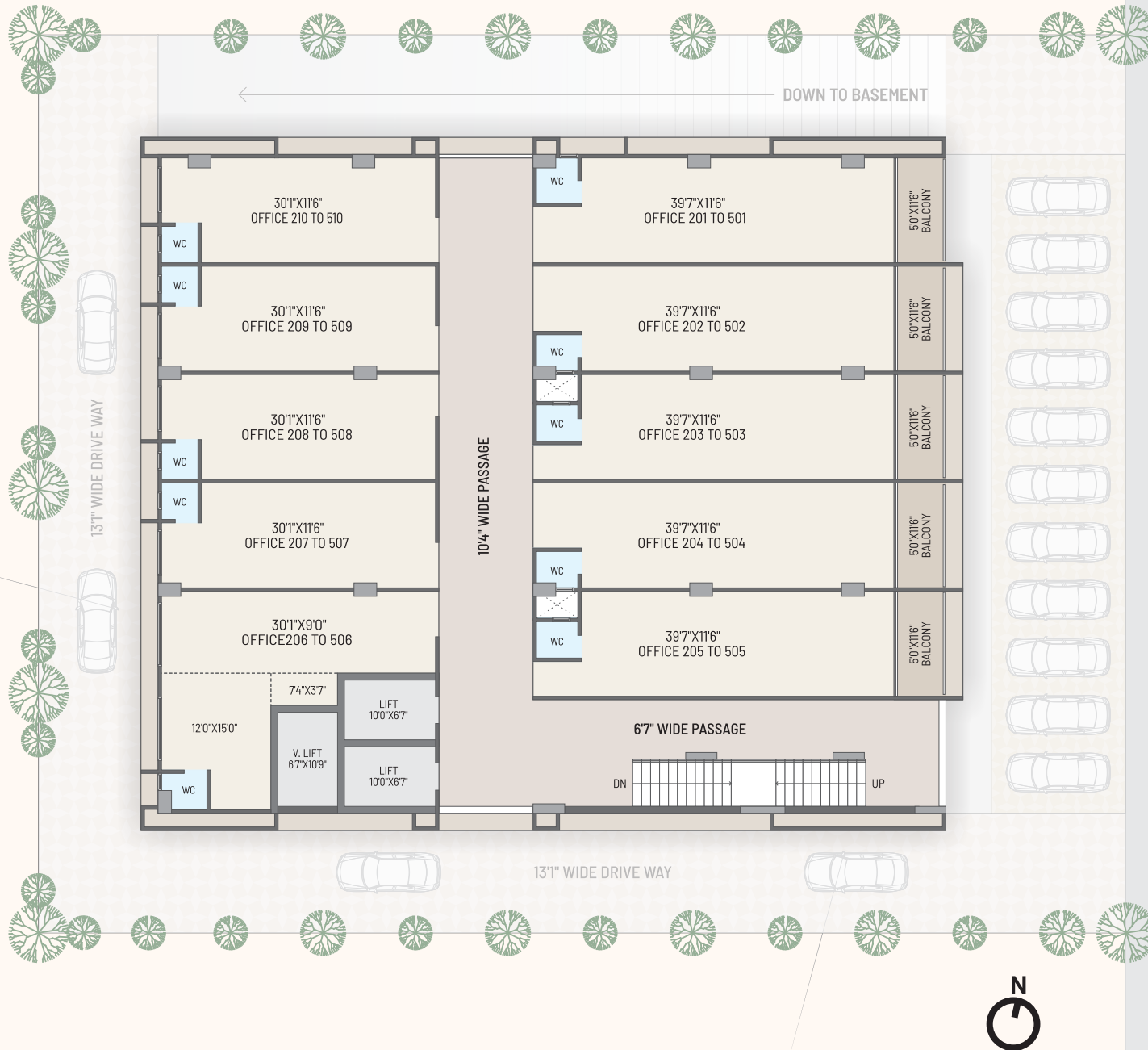



Enjoy hassle-free parking in a single basement facility, providing ample spaces for both offices and visitors. Experience the convenience and security of dedicated parking in our well-planned premises.



**AMPLE  
PARKING**  
single basement



**MECHANICAL  
CAR PARKING**  
at ground floor



**TWO-WHEELER  
TERRACE PARKING**  
with dedicated parking lift



**OPEN SPACE  
PARKING**  
front side of ground floor



**OFFICES THAT WILL  
IMPRESS YOU AND  
YOUR CLIENTS**



## SPECIFICATION

### STRUCTURE:

- Earthquake resistant RCC Frame Structure

### FLOORING:

- Premium Vitrified Tiles • Stone Flooring in Stair

### DOOR:

- Flush Door

### COLOUR:

- Internal: Putty Finish • External: 100% Acrylic Paint

### ELECTRIFICATION:

- Concealed Copper Wiring with Modular Switches & MCB distribution panel

### WINDOW:

- Aluminium Section Windows

### TOILET:

- Glazed/Ceramic Tiles up to lintel level • EWC Couple Closter-CERA or equivalent
- CP Brass fittings-CERA or equivalent





**Govardhan™**  
ASPIRING LEGACY

Beside Sundaram Flora, 80 Ft. Road,  
Opp. Shyam 46, Lambha,  
Ahmedabad, Gujarat. 382405

**95 58 72 72 42**

RERA: PR/GJ/AHMEDABAD/AHMEDABAD CITY/Ahmedabad Municipal Corporation/CAA13844/150724/310329

Email: aarambhsasvat56@gmail.com



Developer



Architect



Structure Eng.



MEPF



Scan QR Code for website

Developers Noted.

• Developers reserves the rights to make necessary changes in the above specifications without any prior notice and such changes would be binding to all members. • Registration, AMC - GEB charges, GST, Govt. Taxes & maintenance charges will be borne by the members. • The information contained in this brochure is subject to change as may be approved by the authorities and cannot form part of any offer or contract. All plans are subject to any amendments approved by the relevant authorities. • Floor areas are approximate and subject to final survey. • Illustrations in this brochure are artistic impressions and serve only to give an approximate idea of the project. While every reasonable care has been taken in providing this information, its owners cannot be held responsible for any inaccuracy. • Subject to Ahmedabad Jurisdiction.